

Table of contents

1 Fire brigade solution according to EN81-72.....	2
1.1 Overview.....	2
1.2 Required components.....	3
1.2.1 In the cabin.....	3
1.2.2 On the fire brigade location and in the machine room.....	3
1.3 Installation: Cabin / Fire brigade location / Machine room.....	4
2 Machine room communication (Intercom).....	5
3 Floor communication (Intercom).....	6
4 Elevator pit (Intercom / Emergency call / Flooding alarm).....	7
5 Lock (Emergency call).....	8
6 Communication unit EA-LMK72x-WG / EA-MINI-V-WG.....	9
6.1 Specification.....	9
6.2 Drilling hole proposal (Schäfer GmbH).....	9
6.3 Connectors.....	9
7 Remote communication unit in IP-box.....	10
7.1 Specification.....	10
7.2 Specification.....	11
8 Programming.....	12
8.1 Dialler EasyAlarm / Exicall.....	12
8.2 Remote communication unit LMK72EC / MINI.....	12
8.3 Calling numbers.....	12
8.4 Program PIN-Code.....	12
8.5 Configuration.....	12
9 Instructions for alarm point.....	13

1 Fire brigade solution according to EN81-72

The fire brigade solution according to EN81-72 from the Leitronic AG can be used by new installations or by back fitting. The System combines the fire brigade communication according to EN81-72 and the normal emergency call according to EN81-28 and EN81-70.

Additional to the components from the Leitronic an analogue land line connection, a screened two or four wire cable (to the fire brigade location, to the cabin and to the machine room) and the supply is required.



1.1 Overview

Fire brigade location

1

3 Button

- 1** Activation of the fire brigade mode with the key switch at the fire brigade location.
- 2** The microphone in the cabin is now activated (talk); Machine room and fire brigade location hear the cabin.
- 3** Push the TALK button.

Machine room

Button **3**

Cabin

- The talking-mode is indicated with the green "Talk"-Symbol.
- The listening-mode is indicated with the yellow "Listen"-Symbol.
- An emergency call in the cabin has higher priority than fire brigade mode.
- The volume can be adjusted on the LMK70x.

1.2 Required components

1.2.1 In the cabin

a) Version EasyAlarm

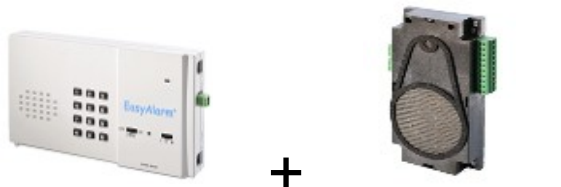

EA-8-DPXM EA-LMK70x-WG
Set Article-No.: EA8 DPXM LMK70x-WG

b) Version Exicall EN70MR



The ringing-signal during dial-in must NOT be forwarded to the remote communication units.

☞ EasyAlarm/Exicall: set register 24 to value 2

☞ *971324## <Announcement of current value> *2#

Exicall EN70MR
Article-No.: 121.5104 (vertical) or 121.5105 (horizontal)

1.2.2 On the fire brigade location and in the machine room



EA-LMK72E-WG Keys switch Button Talk Button Emergency Call (optional)
Article-No.: 118.0202E not included not included not included

Internal LED indicators with light-pipes to front panel
or

External symbols



Listen



Talk

You may also choose a ready to use box in IP-housing or a panel / incl. button(s) and indicators:



EA-IP-EN72
Article-No.: 118.0212E

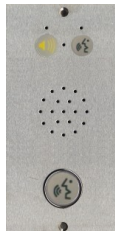

EA-TAB-EN72
Article-No.: 100.0223
Dimension: 10 x 20 cm

1.3 Installation: Cabin / Fire brigade location / Machine room

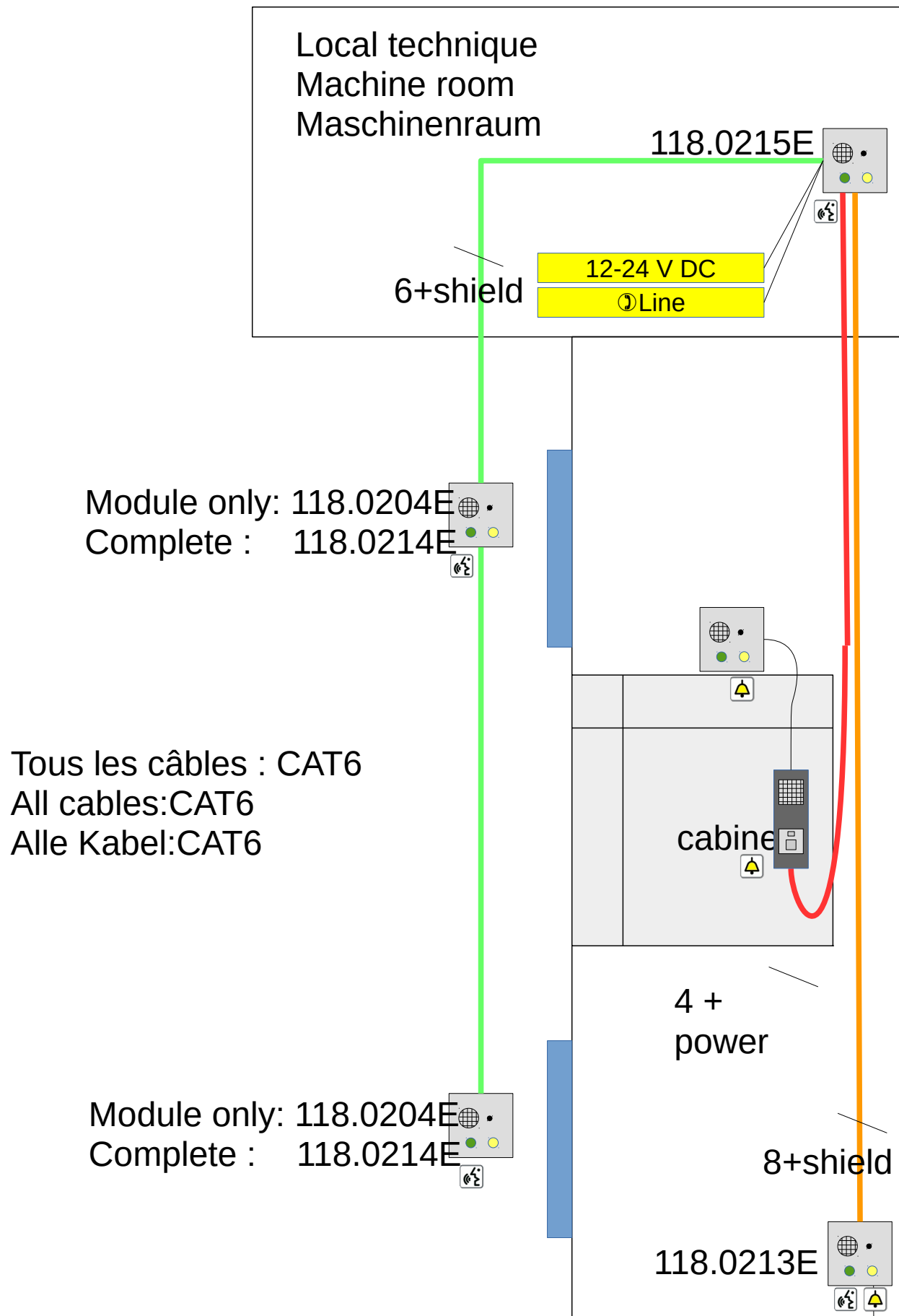

2 Machine room communication (Intercom)

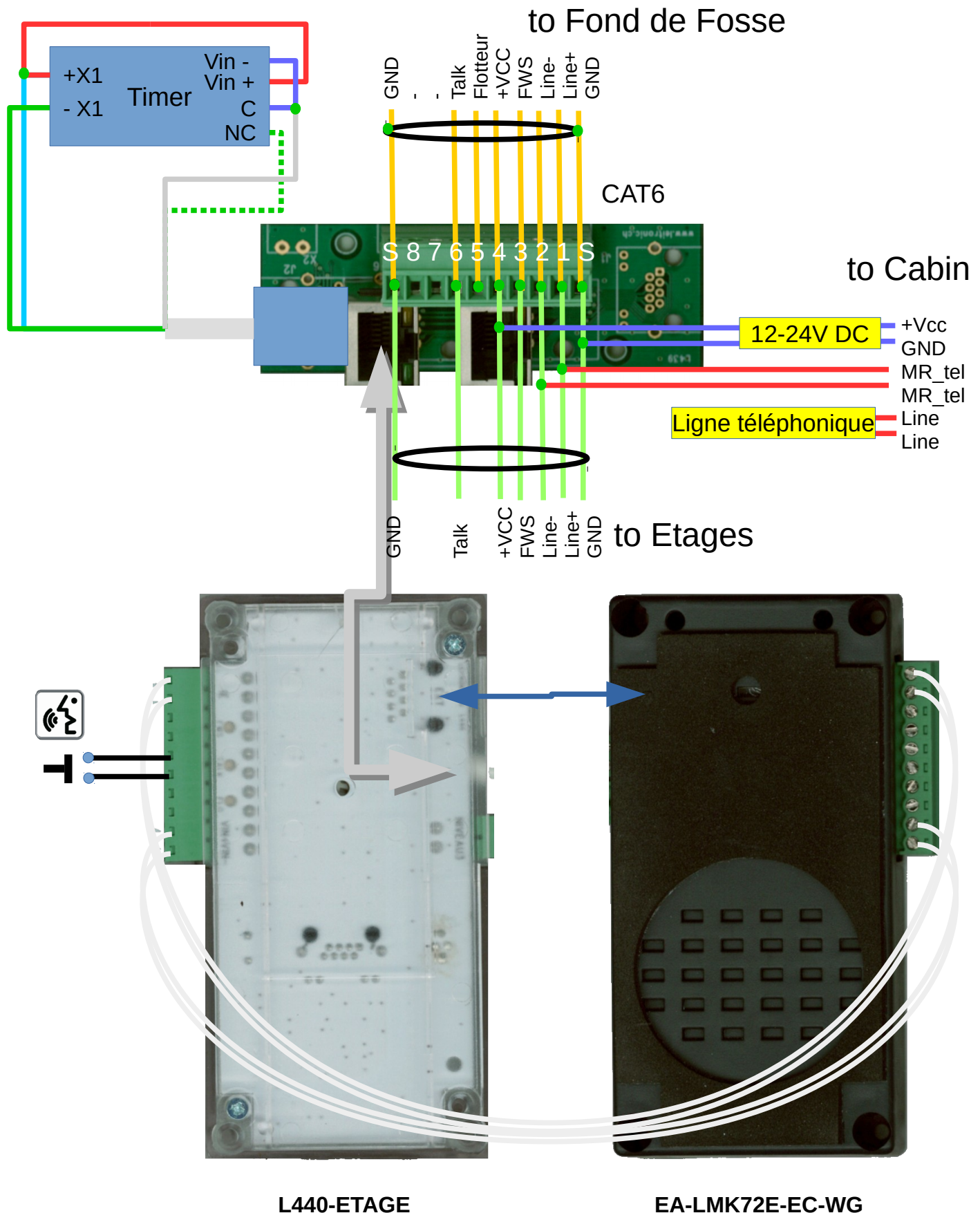

No Programming required

3 Floor communication (Intercom)

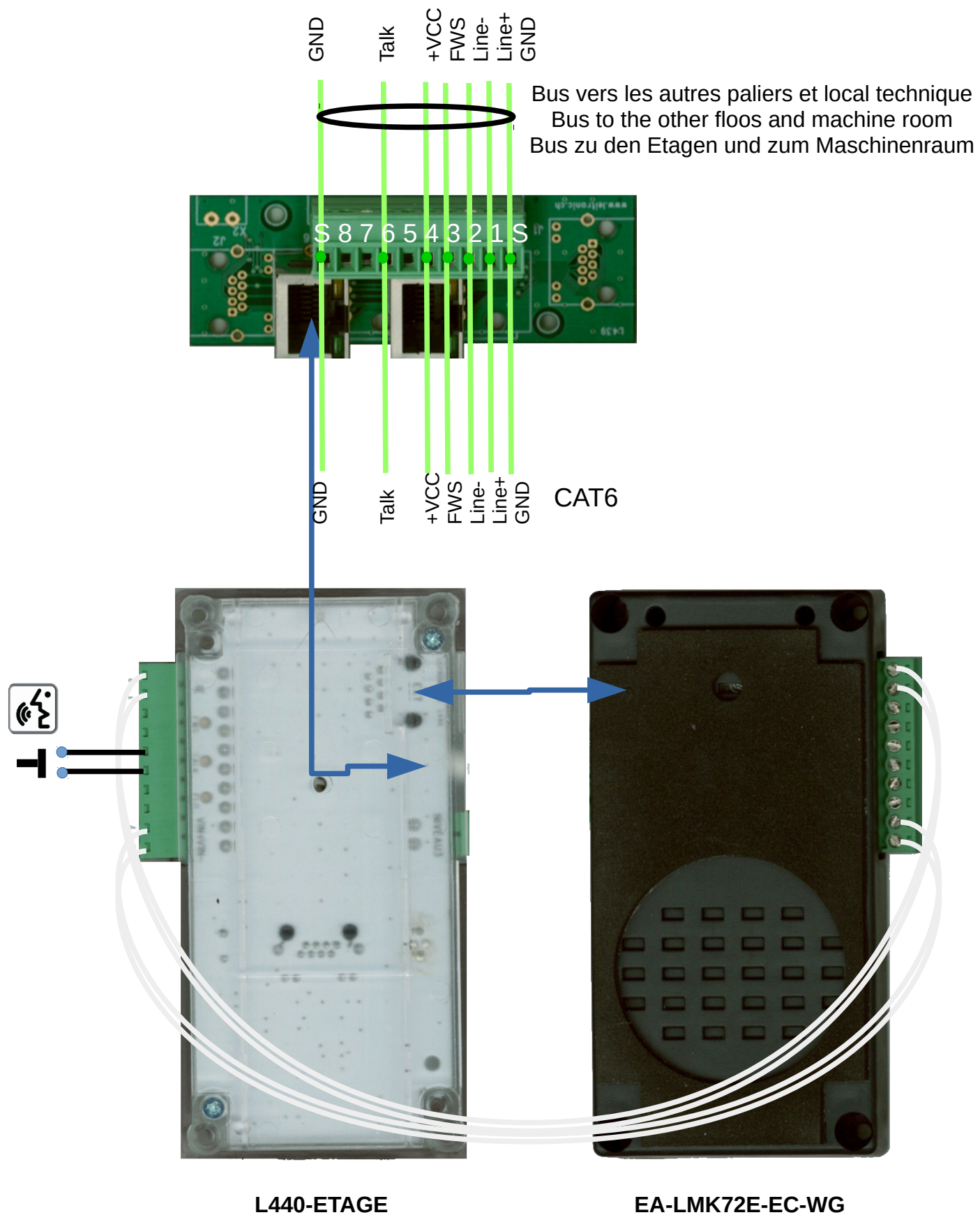

No Programming required

4 Elevator pit (Intercom / Emergency call / Flooding alarm)

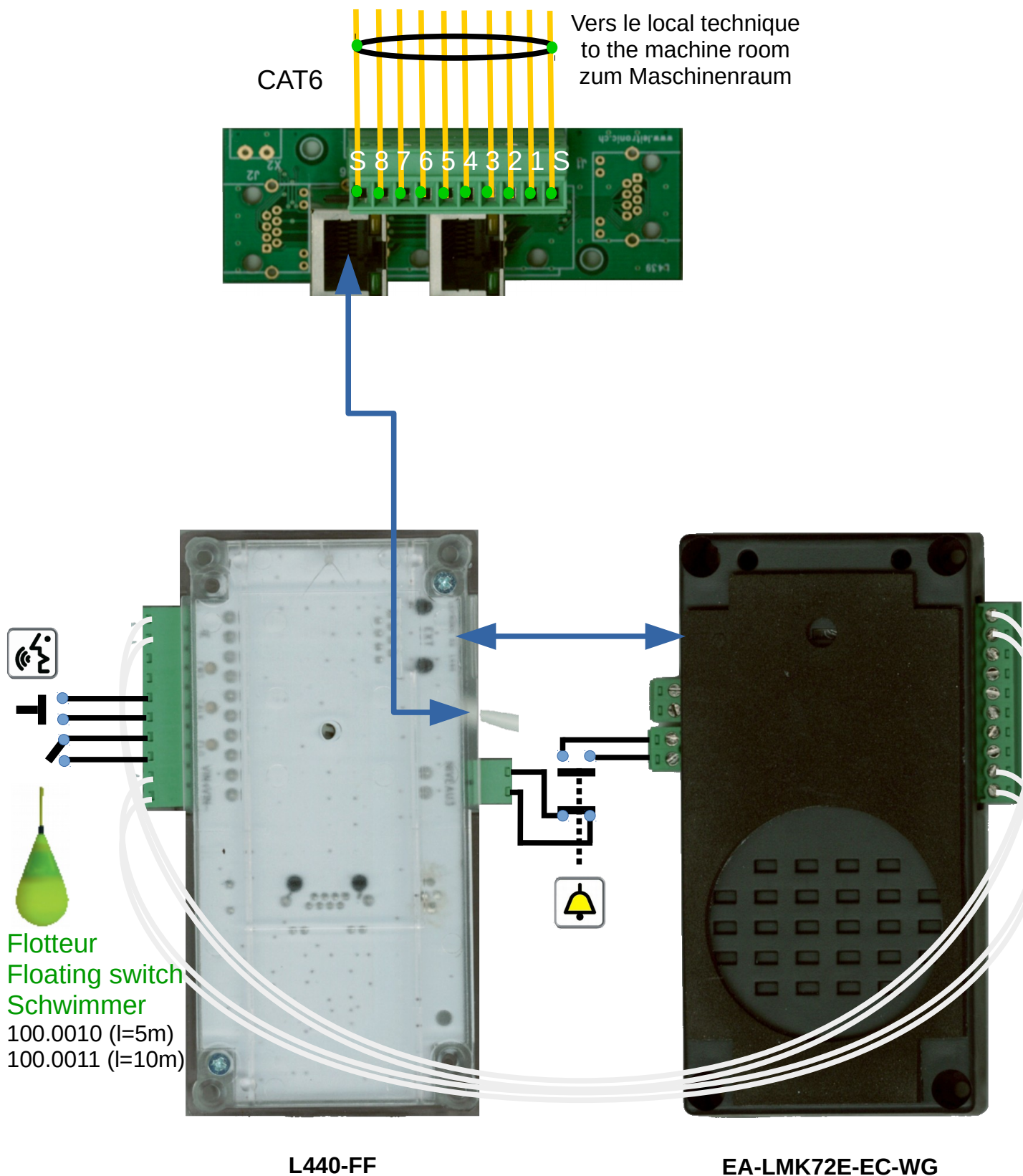

Programming required according to section 8.2

5 Lock (Emergency call)

EA-TAB-EC
100.0221
EA-TABPC-EC
100.0211



EA-IP-EN70
100.0730



VIN: 6 - 24 VDC

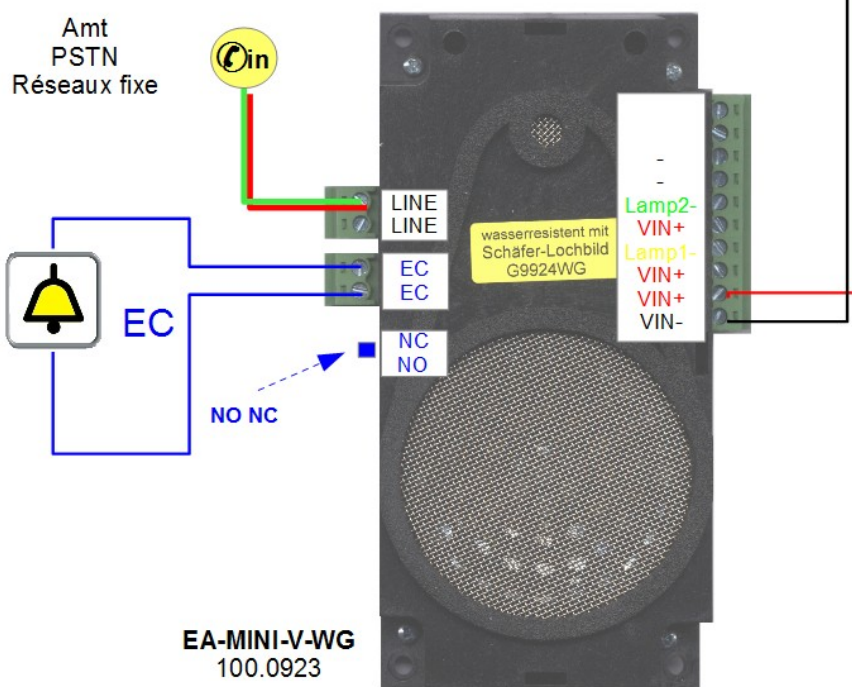

Schleuse
Lock
Sas

Programming required according to section 8.2

6 Communication unit EA-LMK72x-WG / EA-MINI-V-WG

Article-No.	118.0202E	(TALK)
Article-No.	118.0203E	(TALK, EC, S1)
Article-No.	118.0204E	(TALK Etage)
Article-No.	100.0925	(EC)

6.1 Specification

Housing:	ABS with seal ring and front grille
Dimension:	112 x 56 x 21 mm (L x W x H) without plug 112 x 74 x 21 mm (L x W x H) incl. plug
Weight:	100 g

Be aware, that there is NO water protective foil between panel and the LMK-housing. Otherwise it will affect communication quality!

6.2 Drilling hole proposal (Schäfer GmbH)

The built-in LED LMK7x LEDs and two light pipes (Art. No: 25 145 PGN) will lead light to the front: hole diameter $\varnothing = 2.6-0.05\text{mm}$

Order code: "G9924wg LMK70-LED" with holes for light pipes and EN81-70 engraving

Order code: "G9924wg LMK72-LED" with holes for light pipes and EN81-72 engraving

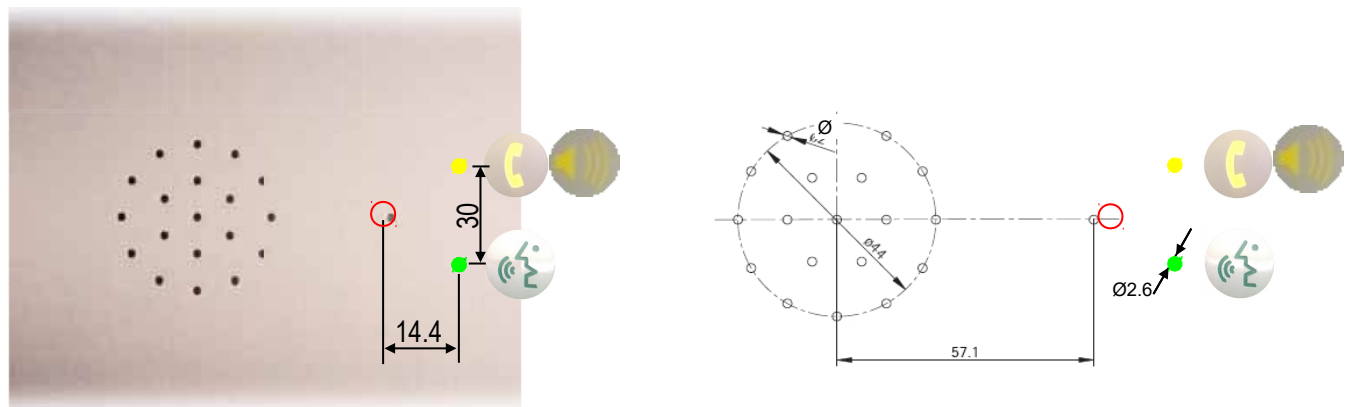

or "G9924wg LMK70" with external symbols: i.e. Type RA42-WG (Schäfer) or similar.

6.3 Connectors

Plug X7 (1..6: free potential / 9..10 $\text{\textcircled{C}}$ -potential)

PIN	Description	Specification	Function
1	VIN(-)	6 .. 24 VDC Standby: 0.4W / Max: 2W	Supply voltage = fire brigade mode
2,3,5	VIN(+)		
4	Lamp1(-)	Open Collector- output (- will be switched) max. 130 mA/output total 1.1A (fuse)	Yellow lamp (Listen)
6	Lamp2(-)		Green lamp (Talk)
9 10	LINE	MR-connection	on $\text{\textcircled{C}}$ -potential

Plug X1 (free potential)

PIN	Description	Specification
1	FWS Fire brigade mode activation	Opto coupler-input 10..50V (AC or DC)
2	FWS Fire brigade mode activation	

Plug X2 118.0202E / 118.0204E (on $\text{\textcircled{C}}$ -potential)

PIN	Description	Specification
1	TALK	Normally open NO
2	TALK	

Plug X2 118.0213E / 100.0925 (on $\text{\textcircled{C}}$ -potential)

PIN	Description	Specification
1	EC	select type with slide switch Normally open NO or Normally closed NC
2	EC	

7 Remote communication unit in IP-box

7.1 Specification

Article-No.	118.0212E	(TALK)
Article-No.	118.0214E	(TALK, Etage)
Housing:	ABS	
Dimension:	110 x 180 x 64 mm (L x W x H) unmounted	
Weight:	400 g (fully assembled)	

Water resistant hole pattern for LMK72M-WG

Talk button: RT-42 2M Sonder Leitronic WG / Symbol Sprechen / Fremdartikelnr: 10011 (12V)

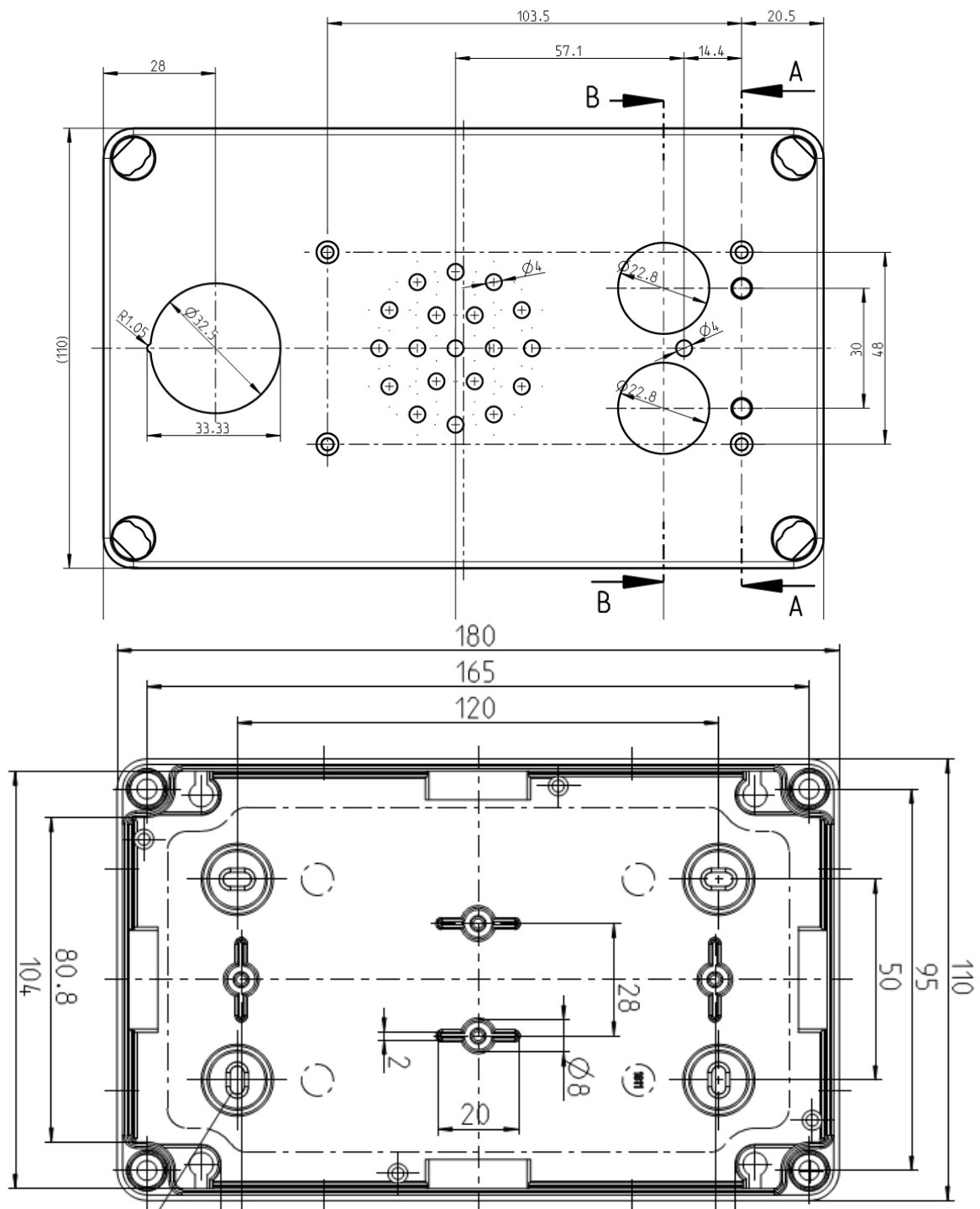

7.2 Specification

Article-No.	118.0213E	(TALK, EC, S1)
Article-No.	118.0215E	(TALK, Etage + Timer)
Housing:	ABS	
Dimension:	180 x 182 x 64 mm (L x W x H) unmounted	
	208 x 182 x 64 mm (L x W x H) mounted incl. M16-feed through	
Weight:	700 g (fully assembled)	

Water resistant hole pattern for LMK72M-WG

Talk button: RT-42 2M Sonder Leitronic WG / Symbol Sprechen / Fremdartikelnr: 10011 (12V)

Emergency button: RT-42 2M Sonder Leitronic WG / Symbol Glocke erhaben / Fremdartikelnr: 10007 (12V)

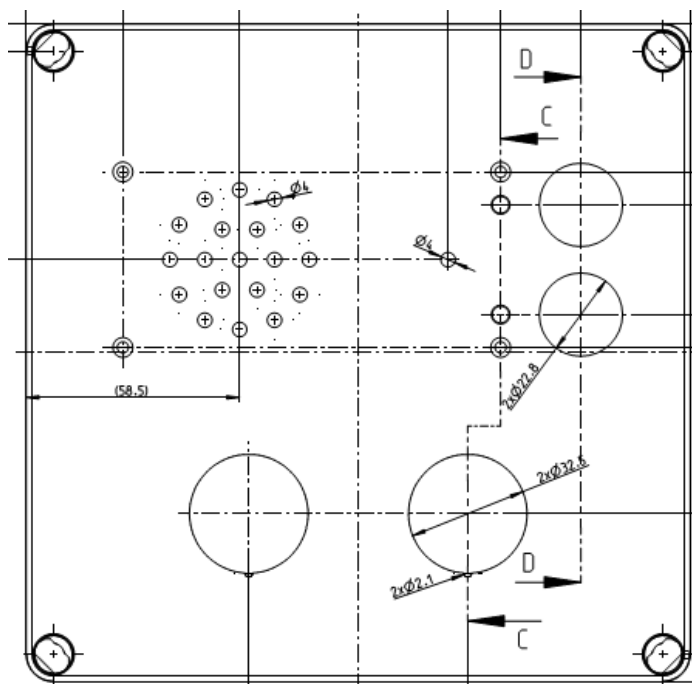
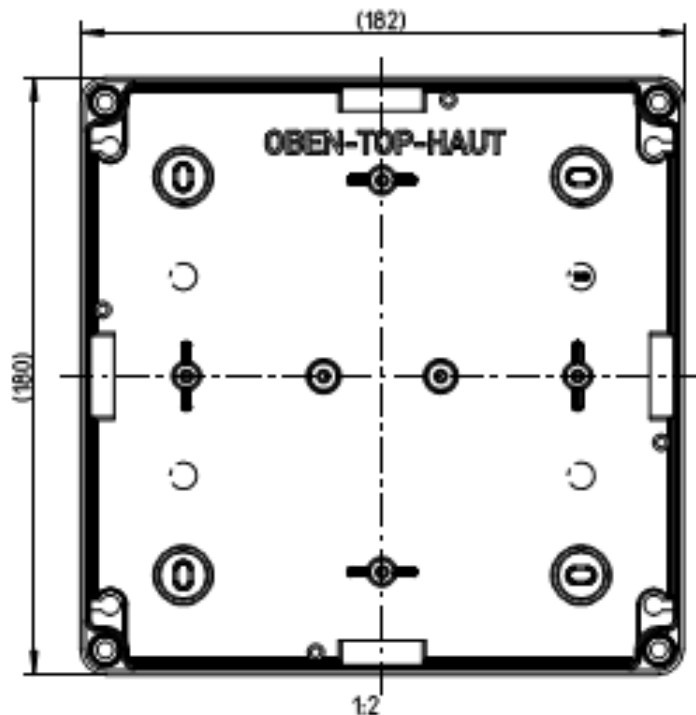

8 Programming

8.1 Dialler EasyAlarm / Exicall

The ringing-signal during dial-in must NOT be forwarded to the remote communication units.

Therefore set register 24 to value 2 ***971324##** <Announcement of current value> ***2#**

8.2 Remote communication unit LMK72EC / MINI

To program, call the line where the LMK72EC / MINI is connected, wait until a beep is audible on the calling telephone. and enter the PIN **1234**. During the telephone connection the unit can be configured by pressing the keys of the calling telephone: (marked in this manual **123456789*0#**)

8.3 Calling numbers

Emergency call **☞** Alarm-number 1..8

Technical alarm **☞** 8

Routine-call **☞** 9

	Function	<Calling-number>: up to 23 digits + #	Factory setting
* * 1	1st alarm-number		
* * 2	2nd alarm-number		#
...	-and so on-		
* * 7	7th alarm-number		#
* * 8	8th alarm-number (Test)		#
* * 9	Routine-number 9 (every 71h)		#

as first digit of calling-number **☞** delete this Alarm number (Alarm sequence stops)

as second digit **☞** Dialling pause before new digit (i.e. to get external line in case of an exchange)

otherwise **☞** Alarm-number completed

Example:

*** * 1 8 8 8 #**

First alarm-number = 888 internal 888

*** * 2 0 # 0 5 6 6 4 8 4 0 4 0 #**

Second alarm-number 2 = 0#0566484040 external

*** * 3 #**

Third alarm-number 3 = End of Alarm

*** * 9 0 # 0 5 6 6 4 8 4 0 4 3 #**

Routine-number 9= 0#0566484043 external

8.4 Program PIN-Code

The pin can be changed by typing: *** * # <PIN-Code> # <PIN-Code> #**

<PIN-Code> is 4 to 7 digits (Factory setting: *** * # 1 2 3 4 # 1 2 3 4 #**)

Successful programming is confirmed by one beep. Two beeps mean error **☞** The old pin remains stored

8.5 Configuration

During telephone connection: *** 9 7 1 3 <Parameter> <Value> # 9 7 1 3 <Parameter> <Value> #**

Successful programming is confirmed by one beep. Two beeps mean error **☞** The old value remains stored

<Parameter>	Function	<Value>	Factory setting
0 0	Software-Version	99 set unit to factory settings	Software-Version
0 4	Delay on # in calling-number	0 .. 15 s	5
2 4	On-hook time (5 + <Value> seconds)	0 .. 255 s	0 ☞ 5s
2 8	Routine call interval	1 .. 254 h	71
3 5	Background-Noise filter BGN	0 Disable 103 Enable	0
4 7	Number of ringing-cycles	0 Dialling-in disabled 1 .. 9	4
4 9	Dial-up time-out in service mode	1 .. 255 x 10s	12 = 120s
5 0	Dial-up time-out in hands-free mode	1 .. 255 x 10s	12 = 120s
5 1	Reload connection time-out	1 .. 255 x 10s	24 = 240s
5 6	S1 Contact type (NO / NC)	33 (NO = Normally open) 35 (NC = Normally closed)	33
6 4	Routine call	1 inactive 3 active	1
6 6	Hands-free volume adjustment	0 .. 15	8
6 9	Activation of the green indicator	1 by DTMF 1 (manual)	1

		4	after the dialling (auto)	
[7][0]	Dialling-in sequence	0	direct / 1 two-step	0
[7][1]	Connection mode after dialling-in (with / without PIN)	0	PIN ↗ Service mode	1
		1	PIN ↗ Hands-free mode	
		7	no PIN ↗ Hands-free mode	
[7][8]	Listen-Timeout (when FWS-Mode is inactive)	1 .. 255 s		60
[7][9]	Activation time for emergency button	0 .. 255 * 20ms		50 = 1s

9 Instructions for alarm point

Answer call

During connection the called party can initiate remote instructions by pressing these keys on the called telephone:

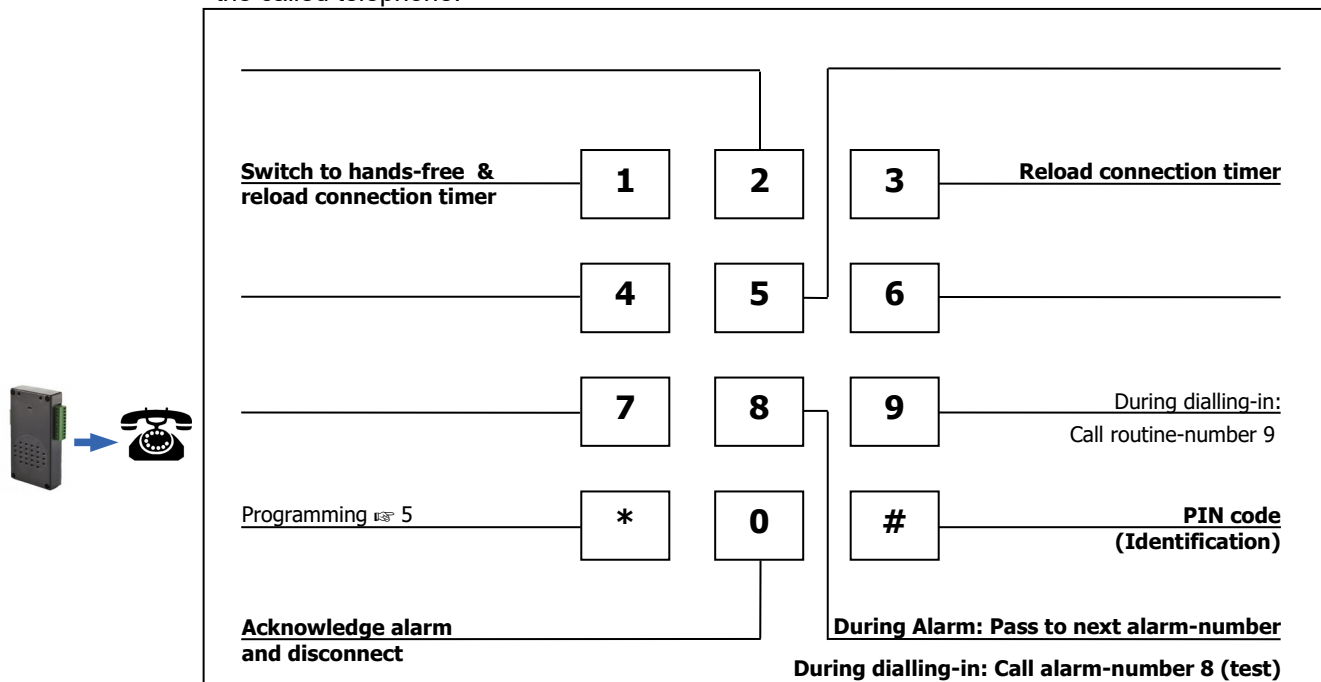

If more than one alarm-number is programmed, the call must be terminated by pressing [0]. Otherwise EA-LMK72M will call the next alarm-number.

Calling back (Access a distance):



1. Dial phone number
2. After two ring EasyAlarm/Exicall answer call asking for PIN ↗ Send DTMF [#]
3. EasyAlarm/Exicall disconnect (and will not answer next call)
4. Re-dial phone number ↗ Access with PIN-Code see below

Access with PIN-Code (Parameter 71=1) (Factory setting)

[1][2][3][4]

After the selected ringing-cycles (Parameter 47, Default = 2) LMK72EC/MINI waits for the PIN-Code (Default = 1234).

After entering correct PIN-code EA-LMK72M establishes a hands-free connection, announced by three beeps to inform any person inside the cabin.